

ORCHESTRA

MOBILE APP QUICK START GUIDE

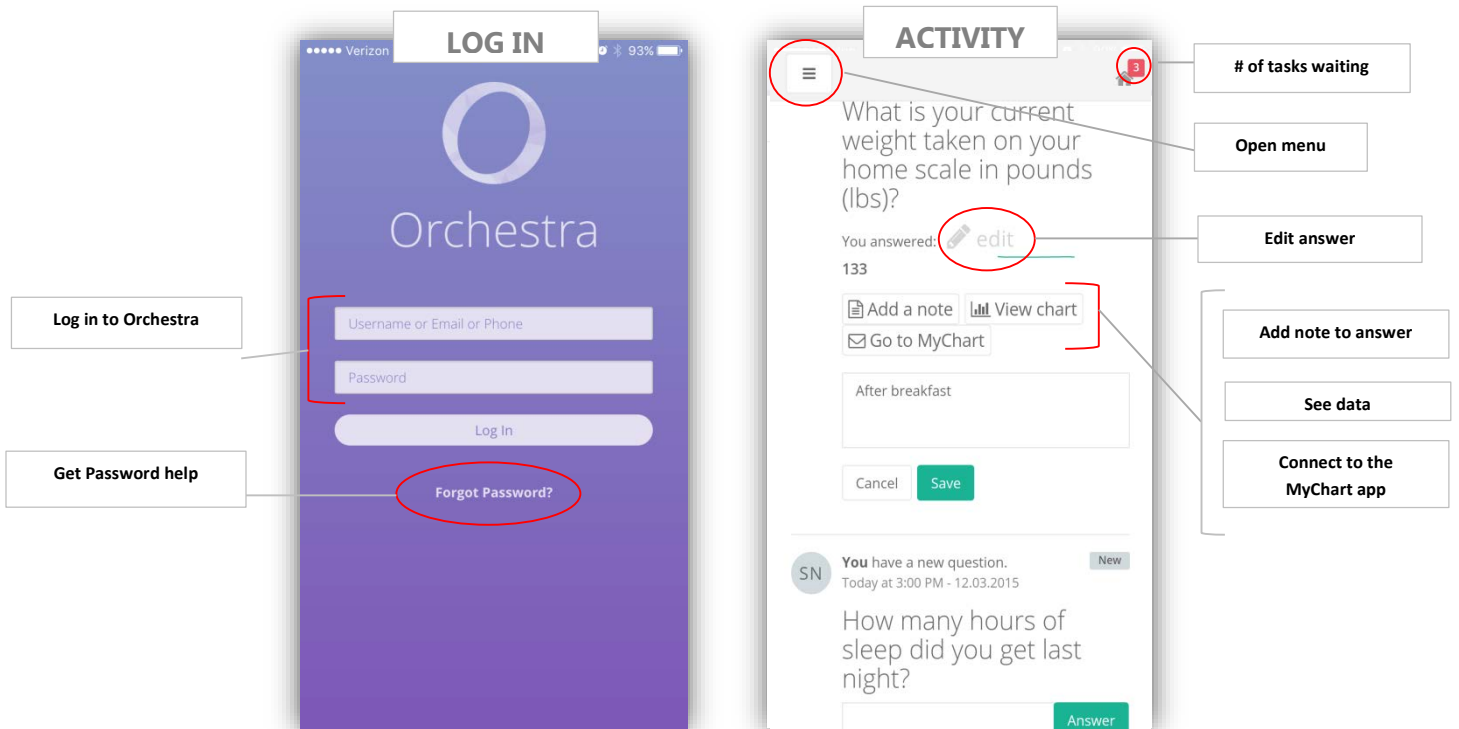

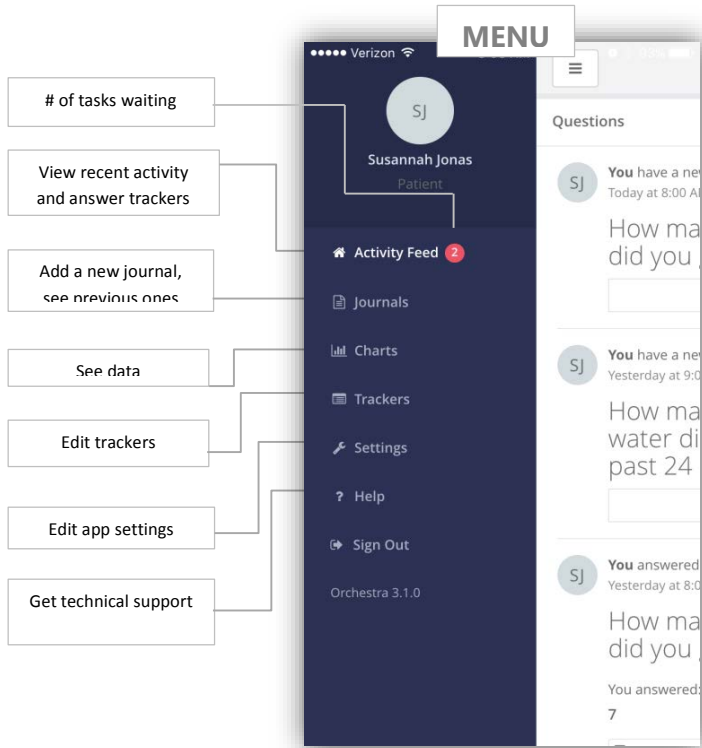

of tasks waiting

View recent activity and answer trackers

Add a new journal, see previous ones

See data

Edit trackers

Edit app settings

Get technical support

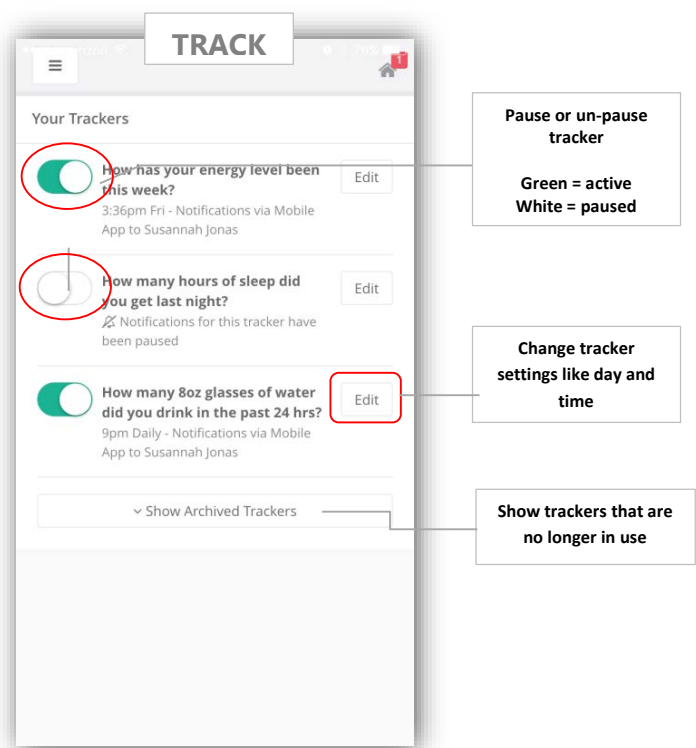

Pause or un-pause tracker

Green = active
White = paused

Change tracker settings like day and time

Show trackers that are no longer in use

CHARTS

View data over a week, month, or year (Callout pointing to Week, Month, Year tabs)

Hide a chart from display (Callout pointing to eye icon on 'How many hours of sleep...')

Yellow dot indicates a note is attached to the data point. Tap to see note (Callout pointing to yellow dot on water intake chart)

Tap any data point to see answer (Callout pointing to data point on water intake chart)

See note or add one (Callout pointing to note area at bottom of water intake chart)

JOURN

New Medication Entry (Callout pointing to 'New Medication Entry' form)

Add information or observations to remember – the care team can see this (Callout pointing to 'What's going on?' text area)

View previous journal and medication entries (Callout pointing to 'Your Journals' list)

To view your Orchestra account in more detail from your laptop or desktop, please visit www.orchestra.md

Username: _____

Password: _____